

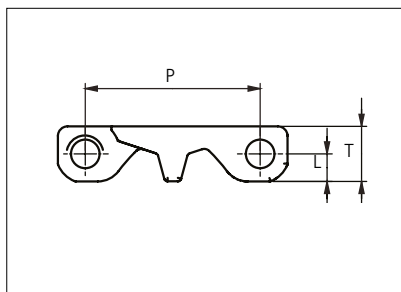

Plastic Modular Belt

Series **uni DTB** Type **Closed**

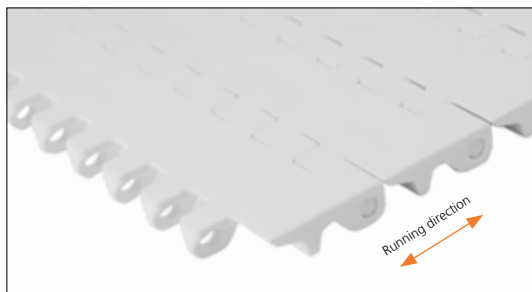

Straight running belt
 Nominal pitch: 50.8 mm (2.00 in)
 Surface type: Flat
 Surface opening: Closed
 Backflex radius: 65.0 mm (2.6 in)
 Pin diameter: 8.00 mm (0.31 in)

Belt material & color	PK-I W B	mm	in	mm	in
Pin material & color	PP W	P (Nominal)	50.8	2.00	T
		L	8.0	0.31	-
					16.0
					0.63

Non standard material and color: See uni Material and Color Overview.

Belt width		Permissible tensile force (Belt/pin material)		Belt weight (Belt/pin material)		*Min. no. drive sprocket per shaft	Number of wear strips (Min. No.)	
		PK-I/PP		PK-I/PP			**Carry (pcs)	**Return (pcs)
mm	in	N	lbf	Kg/m	lb/ft			
402	15.8	7357	1654	4.3	2.90	3	2	2
427	16.8	7814	1757	4.6	3.08	3	2	2
452	17.8	8272	1859	4.8	3.26	4	2	2
477	18.8	8729	1962	5.1	3.44	4	2	2
503	19.8	9205	2069	5.4	3.63	4	3	2
528	20.8	9662	2172	5.7	3.81	4	3	2
553	21.8	10120	2275	5.9	3.99	4	3	2
579	22.8	10596	2382	6.2	4.18	4	3	2
604	23.8	11053	2485	6.5	4.36	5	3	3
629	24.8	11511	2588	6.7	4.54	5	3	3
654	25.7	11968	2690	7.0	4.72	5	3	3
680	26.8	12444	2797	7.3	4.90	5	3	3
705	27.8	12902	2900	7.6	5.08	5	3	3
730	28.7	13359	3003	7.8	5.26	5	3	3
756	29.8	13835	3110	8.1	5.45	6	4	3
781	30.7	14292	3213	8.4	5.63	6	4	3
806	31.7	14750	3316	8.6	5.81	6	4	3
832	32.8	15226	3423	8.9	6.00	6	4	3

Additional standard belt widths are available in steps of 25.4 mm (1.00 in).

908	35.7	16616	3735	9.7	6.55	7	4	4
-----	------	-------	------	-----	------	---	---	---

Additional standard belt widths are available in steps of 25.4 mm (1.00 in).

1060	41.7	19398	4361	11.4	7.64	8	5	4
1085	42.7	19856	4464	11.6	7.82	8	5	4

Width above 42 inch consist of 3 links.

General belt tolerance is +0/-0.4% at 23°C/73°F. For exact belt width contact Customer Service. Non standard belt width on request.

Maxi Link = Assembled with minimum amount of links per row.

*Max. Load per Drive Sprocket. Belt material: PK 1500 N (337 lbf) with Snub roller, PK 1000 N (225 lbf) without Snub roller

**Max. Spacing between wear strips, Carry: 254.0 mm (10.00 in); Return: 305.0 mm (12.00 in).

= Single Link = Assembled with 2 maxi links



uni UltraClean Sprocket

No. of teeth	Bore size			Overall diameter		Pitch-diameter		Hub-diameter		Dimension A		Dimension B		Single row/One way	Moulded	PA6 W
	in	1.50	1.57													
	mm	38.1	40.0	mm	in	mm	in	mm	in	mm	in					
Z8		■	■	132.9	5.23	132.8	5.23	70.0	2.76	53.3	2.10	74.9	2.94	✓	✓	
Z10		■	■	166.3	6.55	164.4	6.47	70.0	2.76	70.2	2.76	90.7	3.57	✓	✓	
Z12		■	■	198.6	7.82	196.3	7.73	70.0	2.76	86.8	3.42	106.6	4.19	✓	✓	

■ Moulded uni UltraClean Sprocket

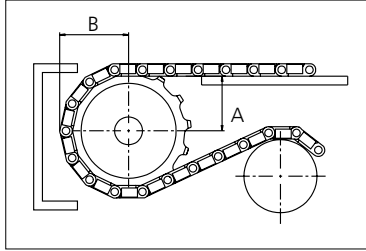

Width of UltraClean sprocket = Single row: 38.0 mm (1.50 in)
 Width of UltraClean sprocket, tooth = Single row: 12.5 mm (0.37 in)

uni Retainer Rings: See uni Retainer Ring data sheet.
 For correct sprocket position: See uni Assembly Instructions for uni DTB.
 For more detailed sprocket information, contact Customer Service.

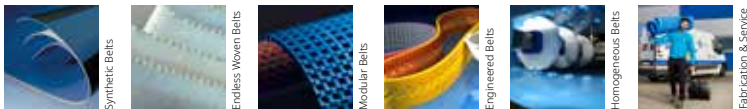

Expert advice and quality solutions for all your belting needs.

ammeraalbeltech.com
eptool.online

Ammeraal Beltech Modular A/S
 Hjulmagervej 21
 DK-7100 Vejle
 T +45 7572 3100

ammega.com

This information is subject to alteration due to continuous development. Ammeraal Beltech will not be held liable for the incorrect use of the above stated information. This information replaces previous information. All activities performed and services rendered by Ammeraal Beltech are subject to general terms and conditions of sale and delivery, as applied by its operating companies.